

# Bank Building

1217 Memorial Parkway, Huntsville, Alabama 35801

For Sale



## Property Overview

<b>Demographics:</b>	<u>1 mile</u>	<u>2 miles</u>
Population:	26,326	69,380
Avg. H.H. Inc.	\$38,560	\$44,806

<b>Traffic Count:</b>	
Memorial Pkwy:	61,330 VPD (2008)
University Dr:	39,350 VPD (2008)

**Zoning:** Light Industry

## Property Details

- ▶ **Size :** 6,405 SF on 20,000 SF Lot
- ▶ **Price :** Call for sealed bid auction package
- ▶ **Location:** Very close to intersection of University Drive & Memorial Parkway
- ▶ **Property offered As-Is**

## Contact Information :

Redge Swing  
rswing@mclaincommercial.com  
Phone : (256) 533-3414 Ext. 137  
Mobile: (256) 714-7144



MCLAIN REAL ESTATE

[www.mclaincommercial.com](http://www.mclaincommercial.com)

228 Holmes Avenue, Suite 200, Huntsville, Alabama 35801  
(256) 533-3414

Coldwell Banker Commercial and the Coldwell Banker Commercial Logo are registered service marks licensed to Coldwell Banker Commercial Affiliates. Each Office is Independently Owned and Operated.

# Bank Building

1217 Memorial Parkway, Huntsville, Alabama 35801

For Sale

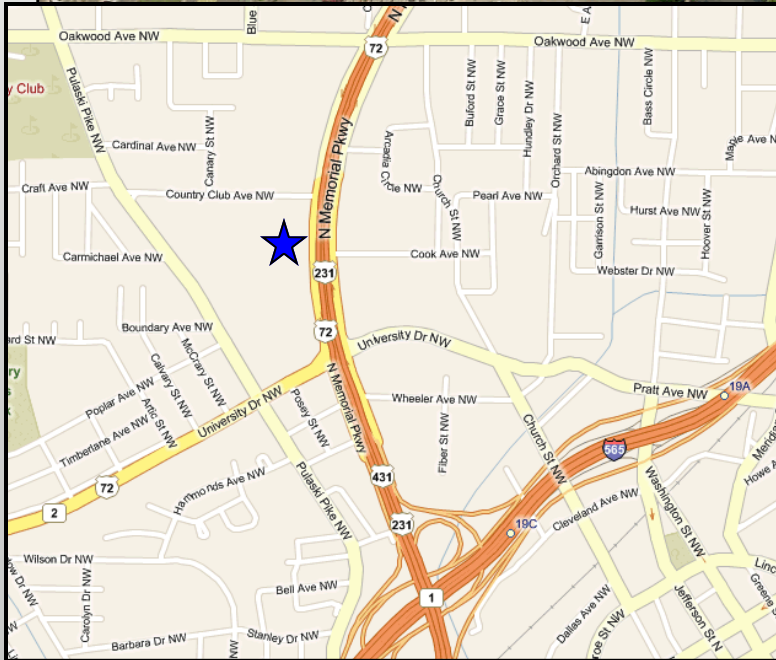
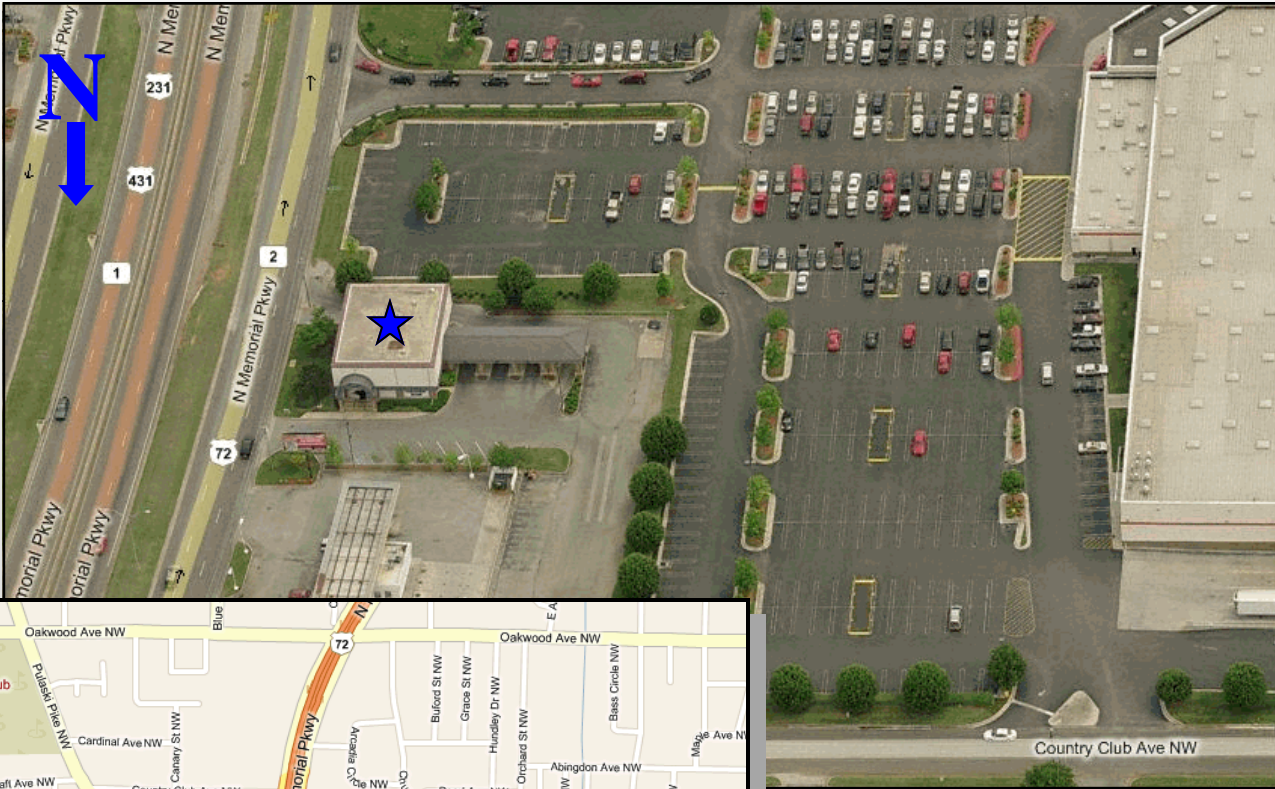

## Contact Information :

Redge Swing  
rswing@mclaincommercial.com  
Phone : (256) 533-3414 Ext. 137  
Mobile: (256) 714-7144



MCLAIN REAL ESTATE

[www.mclaincommercial.com](http://www.mclaincommercial.com)

228 Holmes Avenue, Suite 200, Huntsville, Alabama 35801  
(256) 533-3414

Coldwell Banker Commercial and the Coldwell Banker Commercial Logo are registered service marks licensed to Coldwell Banker Commercial Affiliates. Each Office is Independently Owned and Operated.